

Alu blind rivet nuts

Material: AlMg 3

Standard (Dome head)

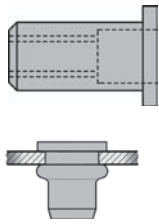

	Rivet body D ₁ x L mm	Grip range mm	Part no.	Quantity per box
M 4 Hole Ø: 6.1 mm	6 x 11.0	0.25 - 3.0	641 0030	A 500
	6 x 13.0	2.5 - 4.5	641 0073	"
M 5 Hole Ø: 7.1 mm	7 x 11.5	0.25 - 3.0	641 0138	A 500
	7 x 13.5	2.5 - 5.0	641 0170	"
M 6 Hole Ø: 9.1 mm	9 x 15.5	0.25 - 3.5	641 0235	A 250
	9 x 18.0	3.0 - 5.5	641 0278	"
M 8 Hole Ø: 11.1 mm	11 x 17.0	0.25 - 3.5	641 0332	A 100
	11 x 20.0	3.0 - 6.0	641 0367	"
M 10 Hole Ø: 12.1 mm	12 x 17.5	0.25 - 3.5	641 0456	A 100
	12 x 20.5	3.0 - 6.0	641 0480	"

Small head

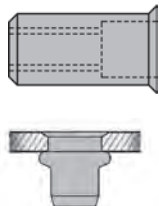

	Rivet body D ₁ x L mm	Rivet body D ₁ x L mm	Part no.	Quantity per box
M 4 Hole Ø: 6.1 mm	6 x 12.0	0.5 - 3.0	641 0553	A 500
M 5 Hole Ø: 7.1 mm	7 x 12.5	0.5 - 3.0	641 0650	A 500
M 6 Hole Ø: 9.1 mm	9 x 15.5	0.5 - 3.5	641 0758	A 250
M 8 Hole Ø: 11.1 mm	11 x 17.0	0.5 - 3.5	641 0766	A 100

Countersunk (90°)

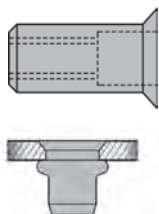

	Rivet body D ₁ x L mm	Rivet body D ₁ x L mm	Part no.	Quantity per box
M 4 Hole Ø: 6.1 mm	6 x 12.0	1.5 - 3.5	641 2017	A 500
	6 x 13.5	3.0 - 5.0	641 2041	"
M 5 Hole Ø: 7.1 mm	7 x 13.5	1.5 - 4.0	641 2130	A 500
	7 x 15.5	3.5 - 6.0	641 2149	"
M 6 Hole Ø: 9.1 mm	9 x 17.0	1.5 - 4.5	641 2238	A 250
	9 x 19.0	4.0 - 6.5	641 2246	"
M 8 Hole Ø: 11.1 mm	11 x 18.5	1.5 - 4.5	641 2335	A 100
	11 x 20.5	4.0 - 6.5	641 2343	"
M 10 Hole Ø: 12.1 mm	12 x 19.0	1.5 - 4.5	641 2432	A 100
	12 x 21.0	4.0 - 6.5	641 2440	"

The maximum tightening torque and the thread breaking force and shear strengths for all blind rivet nuts can be found on pages 102 and 103.

Steel blind rivet nuts

Material: Steel, zinc-plated

Standard (Dome head)

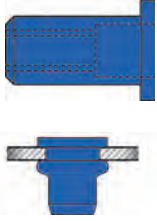

	Rivet body D ₁ x L mm	Grip range mm	Part no.	Quantity per box
M 4 Hole Ø: 6.1 mm	6 x 11.0	0.25 - 3.0	642 0052	A 500
	6 x 13.0	2.5 - 4.5	642 0095	"
M 5 Hole Ø: 7.1 mm	7 x 11.5	0.25 - 3.0	642 0176	A 500
	7 x 13.5	2.5 - 5.0	642 0214	"
M 6 Hole Ø: 9.1 mm	9 x 15.5	0.25 - 3.5	642 0273	A 250
	9 x 18.0	3.0 - 5.5	642 0338	"
M 8 Hole Ø: 11.1 mm	11 x 17.0	0.25 - 3.5	642 0397	A 100
	11 x 20.0	3.0 - 6.0	642 0427	"
M 10 Hole Ø: 12.1 mm	12 x 17.5	0.25 - 3.5	642 0494	A 100
	12 x 20.5	3.0 - 6.0	642 0524	"

Small head

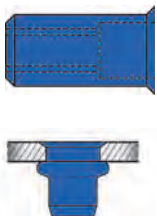

	Rivet body D ₁ x L mm	Grip range mm	Part no.	Quantity per box
M 4 Hole Ø: 6.1 mm	6 x 12.0	0.25 - 3.0	642 0613	A 500
M 5 Hole Ø: 7.1 mm	7 x 12.5	0.25 - 3.0	642 0710	A 500
M 6 Hole Ø: 9.1 mm	9 x 15.5	0.25 - 3.5	642 0818	A 250
M 8 Hole Ø: 11.1 mm	11 x 17.0	0.25 - 3.5	642 0826	A 100

Countersunk (90°)

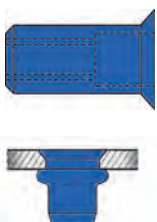

	Rivet body D ₁ x L mm	Grip range mm	Part no.	Quantity per box
M 4 Hole Ø: 6.1 mm	6 x 12.0	1.5 - 3.5	642 2012	A 500
	6 x 13.5	3.0 - 5.0	642 2047	"
M 5 Hole Ø: 7.1 mm	7 x 13.5	1.5 - 4.0	642 2144	A 500
	7 x 15.5	3.5 - 6.0	642 2152	"
M 6 Hole Ø: 9.1 mm	9 x 17.0	1.5 - 4.5	642 2233	A 250
	9 x 19.0	4.0 - 6.5	642 2241	"
M 8 Hole Ø: 11.1 mm	11 x 18.5	1.5 - 4.5	642 2330	A 100
	11 x 20.5	4.0 - 6.5	642 2349	"
M 10 Hole Ø: 12.1 mm	12 x 19.0	1.5 - 4.5	642 2438	A 100
	12 x 21.0	4.0 - 6.5	642 2446	"

The maximum tightening torque and the thread breaking force and shear strengths for all blind rivet nuts can be found on pages 102 and 103.

Blind rivet nuts

Steel-splined

Material: Steel, zinc-plated

Standard (Dome head)



	Rivet body D ₁ x L mm	Grip range mm	Part no.	Quantity per box
M 4 Hole Ø: 6.1 mm	6 x 11.0	0.25 - 3.0	642 4503	A 500
	6 x 13.0	2.5 - 4.5	642 4511	"
M 5 Hole Ø: 7.1 mm	7 x 11.5	0.25 - 3.0	642 4538	A 500
	7 x 13.5	2.5 - 5.0	642 4546	"
M 6 Hole Ø: 9.1 mm	9 x 15.5	0.25 - 3.5	642 4554	A 250
	9 x 18.0	3.0 - 5.5	642 4562	"
M 8 Hole Ø: 11.1 mm	11 x 17.0	0.25 - 3.5	642 4570	A 100
	11 x 20.0	3.0 - 6.0	642 4589	"

Small head



	Rivet body D ₁ x L mm	Grip range mm	Part no.	Quantity per box
M 4 Hole Ø: 6.1 mm	6 x 12.0	0.25 - 3.0	642 4708	A 500
M 5 Hole Ø: 7.1 mm	7 x 12.5	0.25 - 3.0	642 4716	A 500
M 6 Hole Ø: 9.1 mm	9 x 15.5	0.25 - 3.5	642 4724	A 250
M 8 Hole Ø: 11.1 mm	11 x 17.0	0.25 - 3.5	642 4732	A 100

Countersunk



	Rivet body D ₁ x L mm	Grip range mm	Part no.	Quantity per box
M 4 Hole Ø: 6.1 mm	6 x 12.0	1.5 - 3.5	642 4600	A 500
	6 x 13.5	3.0 - 5.0	642 4619	"
M 5 Hole Ø: 7.1 mm	7 x 13.5	1.5 - 4.0	642 4627	A 500
	7 x 15.5	3.5 - 6.0	642 4635	"
M 6 Hole Ø: 9.1 mm	9 x 17.0	1.5 - 4.5	642 4643	A 250
	9 x 19.0	4.0 - 6.5	642 4651	"
M 8 Hole Ø: 11.1 mm	11 x 18.5	1.5 - 4.5	642 4678	A 100
	11 x 20.5	4.0 - 6.5	642 4686	"

Blind rivet nuts

Steel-hexagonal

Material: Steel, zinc-plated

Standard (Dome head)



	Rivet body D ₁ x L mm	Grip range mm	Part no.	Quantity per box
M 4 SW6 +0.1	6 x 11.0	0.5 - 2.0	642 4007	A 500
M 5 SW7 +0.1	7 x 12.0	0.5 - 3.0	642 4015	A 500
M 6 SW9 +0.1	9 x 15.5	0.5 - 3.0	642 4023	A 250
M 8 SW11 +0.1	11 x 17.0	0.5 - 3.0	642 4031	A 100

Small head



	Rivet body D ₁ x L mm	Grip range mm	Part no.	Quantity per box
M 4 SW6 +0.1	6 x 11.0	0.5 - 2.0	642 4309	A 500
M 5 SW7 +0.1	7 x 12.5	0.5 - 3.0	642 4317	A 500
M 6 SW9 +0.1	9 x 15.5	0.5 - 3.0	642 4325	A 250
M 8 SW11 +0.1	11 x 17.0	0.5 - 3.0	642 4333	A 100

The maximum tightening torque and the thread breaking force and shear strengths for all blind rivet nuts can be found on pages 102 and 103.

Blind rivet nuts

Stainless steel

Material:
Stainless steel A2 1.4567



Standard (Dome head)



	Rivet body D ₁ x L mm	Grip range mm	Part no.	Quantity per box
M 4 Hole Ø: 6.1 mm	6 x 11.0	0.25 - 3.0	643 0007	A 500
	6 x 13.0	2.5 - 4.0	643 0015	"
M 5 Hole Ø: 7.1 mm	7 x 11.5	0.25 - 3.0	643 0104	A 500
	7 x 13.5	2.5 - 4.5	643 0112	"
M 6 Hole Ø: 9.1 mm	9 x 15.5	0.25 - 3.5	643 0201	A 250
	9 x 18.0	3.0 - 5.5	643 0228	"
M 8 Hole Ø: 11.1 mm	11 x 17.0	0.25 - 3.5	643 0309	A 100
	11 x 20.0	3.0 - 6.0	643 0317	"

Material surcharge will be added at a daily rate

Small head



	Rivet body D ₁ x L mm	Grip range mm	Part no.	Quantity per box
M 4 Hole Ø: 6.1 mm	6 x 12.0	0.25 - 3.0	643 0503	A 500
M 5 Hole Ø: 7.1 mm	7 x 12.5	0.25 - 3.0	643 0600	A 500
M 6 Hole Ø: 9.1 mm	9 x 15.5	0.25 - 3.5	643 0708	A 250
M 8 Hole Ø: 11.1 mm	11 x 17.0	0.25 - 3.5	643 0805	A 100

Material surcharge will be added at a daily rate

Countersunk



	Rivet body D ₁ x L mm	Grip range mm	Part no.	Quantity per box
M 4 Hole Ø: 6.1 mm	6 x 12.0	1.5 - 3.0	643 2018	A 500
	6 x 13.0	2.5 - 4.0	643 2026	"
M 5 Hole Ø: 7.1 mm	7 x 13.5	1.5 - 4.0	643 2107	A 500
	7 x 15.5	3.5 - 6.0	643 2115	"
M 6 Hole Ø: 9.1 mm	9 x 17.0	1.5 - 4.5	643 2204	A 250
	9 x 18.5	4.0 - 6.0	643 2212	"
M 8 Hole Ø: 11.1 mm	11 x 18.5	1.5 - 4.5	643 2301	A 100
	11 x 20.0	4.0 - 6.0	643 2328	"

Material surcharge
will be added
at a daily rate

Material Size mm	All materials		Steel-hexagonal	
	Head diameter (mm)		Head diameter (mm)	
	Dome/countersunk	Small head	Dome/countersunk	Small head
M 4	9	7.1	9	7.4
M 5	10	8.1	10	8.4
M 6	12	10.1	13	10.4
M 8	14	12.1	15.8	12.4
M 10	15	./.	./.	./.

The maximum tightening torque and the thread breaking force and shear strengths for all blind rivet nuts can be found on pages 102 and 103.

PolyGrip® blind rivet nuts with large grip range

Aluminium

Standard (Dome head)

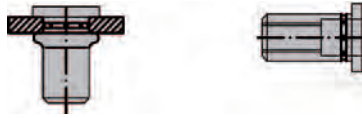

Material: AlMg 2.5

	Rivet body D, x L mm	Grip range mm	Part no.	Quantity per box
M 5 Hole Ø: 7.1 mm	7 x 13.5	0.25 - 5.0	655 0171	A 500
M 6 Hole Ø: 9.1 mm	9 x 18.0	0.25 - 6.0	655 0277	A 250
M 8 Hole Ø: 11.1 mm	11 x 20.0	0.5 - 6.5	655 0366	A 100

Steel

Standard (Dome head)

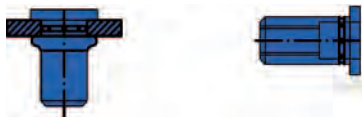

Material: Steel
Surface: Zinc-plated

	Rivet body D, x L mm	Grip range mm	Part no.	Quantity per box
M 5 Hole Ø: 7.1 mm	7 x 13.5	0.25 - 5.0	656 0213	A 500
M 6 Hole Ø: 9.1 mm	9 x 18.0	0.25 - 6.0	656 0338	A 250
M 8 Hole Ø: 11.1 mm	11 x 20.0	0.5 - 6.5	656 0426	A 100

Stainless steel

Standard (Dome head)



Material: Stainless steel A2 1.4567, polished



	Rivet body D, x L mm	Grip range mm	Part no.	Quantity per box
M 5 Hole Ø: 7.1 mm	7 x 13.5	0.25 - 5.0	657 0113	A 500
M 6 Hole Ø: 9.1 mm	9 x 18.0	0.5 - 6.0	657 0227	A 250
M 8 Hole Ø: 11.1 mm	11 x 20.0	0.5 - 6.5	657 0366	A 100

The maximum tightening torque and the thread breaking force and shear strengths for all blind rivet nuts can be found on pages 102 and 103.

Steel blind rivet stud nuts



As a combination of blind rivet nut and screw, blind rivet nut studs offer an alternative or replacement for welding studs.

The following applications are particularly suitable for the use of GESIPA® blind rivet nut studs:

- Accessibility from one side only
- Thin carrier materials (sheet metal, plastics, etc...)
- Necessary pre-centering
- On application materials where thermal effects are possible (e.g. welding)
- Surface coatings must not be damaged
- Production of electrically conductive connections
- Fast replacement of weld studs (repairs)

GESIPA® blind rivet nut studs can be set without any problem with the GESIPA® blind rivet nut setting tools FireBird®, GBM 95 and FireFox® using corresponding adapters (see tool description) for blind rivet nut studs.

Further dimensions, special surface treatments or materials are available on request.

Standard (Dome head)

Material: Steel, zinc-plated

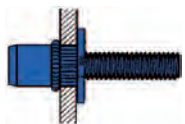

	Rivet body D _i x L mm	Grip range mm	Thread protrusion min. mm	Part no.	Quantity per box
M 4 Hole Ø: 6.1 mm	6 x 11.0	0.25 - 3.0	10.0	638 1010	A 200
M 5 Hole Ø: 7.1 mm	7 x 11.5	0.25 - 3.0	11.5	638 1018	A 150
M 6 Hole Ø: 9.1 mm	9 x 15.5	0.25 - 3.0	13	638 1027	A 150
M 8 Hole Ø: 11.1 mm	11 x 17.0	0.25 - 3.0	15.5	638 1035	A 100

Size mm	Shear strength N (kp)	Tensile strength N (kp)	Max. torque Nm
M 4	5,160 (525)	6,030 (614)	3.0
M 5	7,200 (733)	10,800 (1,100)	6.0
M 6	10,800 (1,100)	17,800 (1,812)	13.0
M 8	18,400 (1,873)	27,800 (2,830)	26.0

The values were determined using a screw of the strength class 8.8.